

SGS Device Onboarding - macOS



ICT – How-To Guide

Last Updated: 20.01.2022

Click the Wi-Fi icon near the clock and connect to “SGS-Onboarding” and use “onboardme” as the password.

NOTE: If onboarding from home, please skip to Page 2.

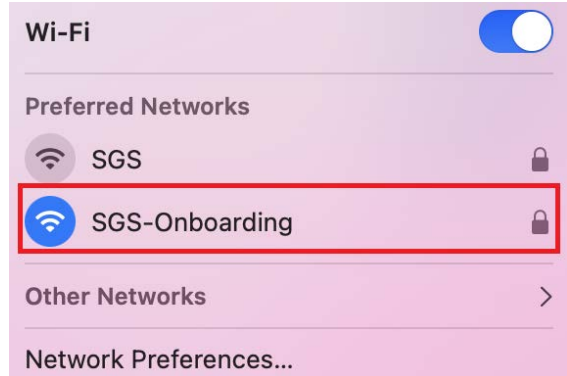

Open Safari and navigate to “portal.manage.microsoft.com” and sign in with your Scone Grammar school account.

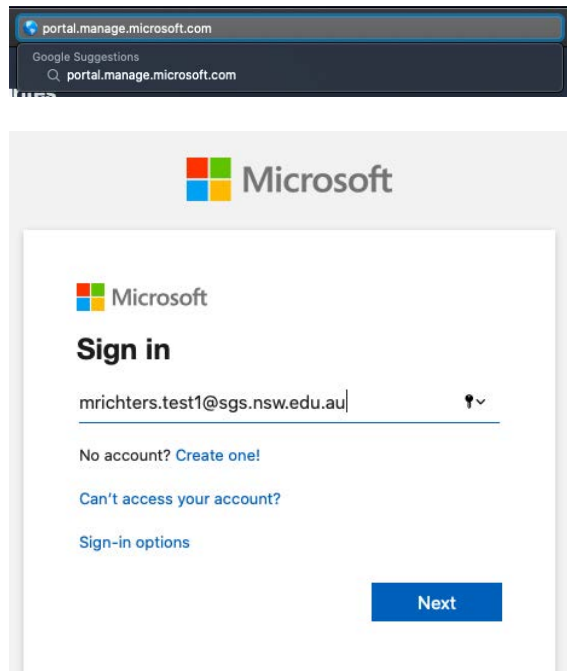

Save the password if asked, tick “Don’t show this again” and click “Yes” to continue.

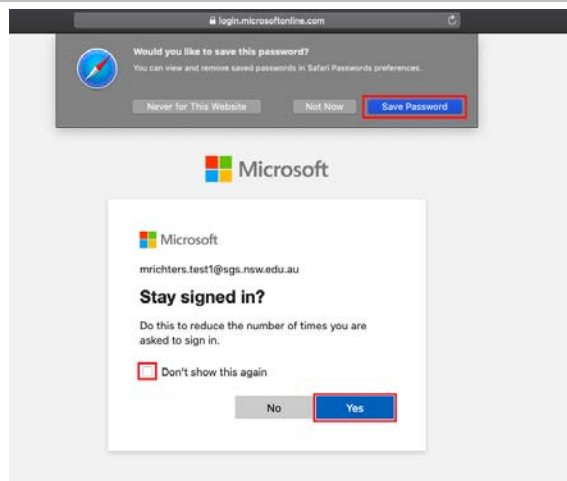

SGS Device Onboarding - macOS



ICT – How-To Guide

Last Updated: 20.01.2022

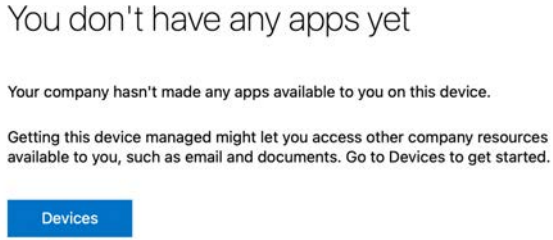
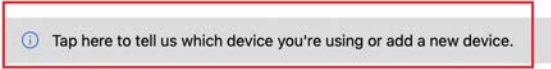
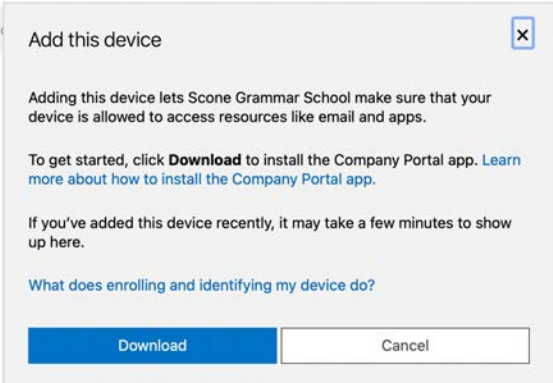
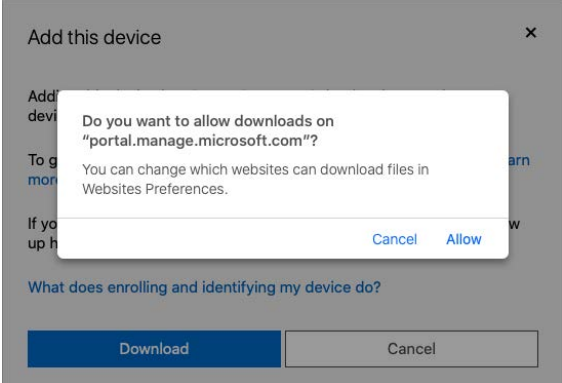
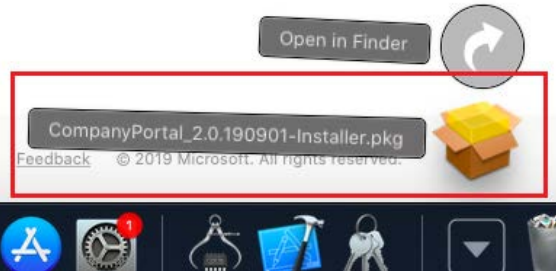
<p>Click “Devices”</p>	
<p>Click the “Tap here to tell us which device you’re using or add a new device” to select the correct devices.</p>	
<p>Click “Download”</p>	
<p>Click “Allow” to allow the download if asked.</p>	
<p>Once the download is complete, open “CompanyPortal-Installer” from the Downloads list.</p>	

SGS Device Onboarding - macOS



ICT – How-To Guide

Last Updated: 20.01.2022

Click “Continue” to commence the install.

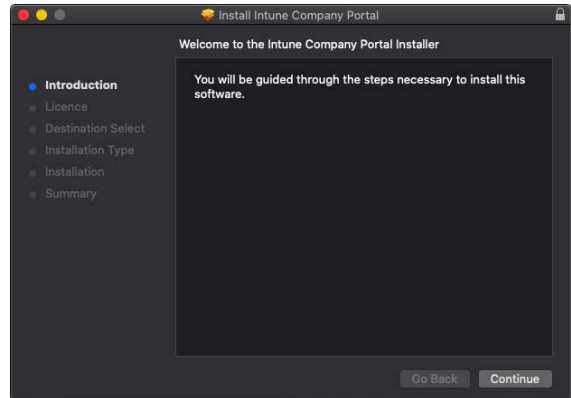

Click “Continue” and “Agree” on the End User Licensing Agreement.

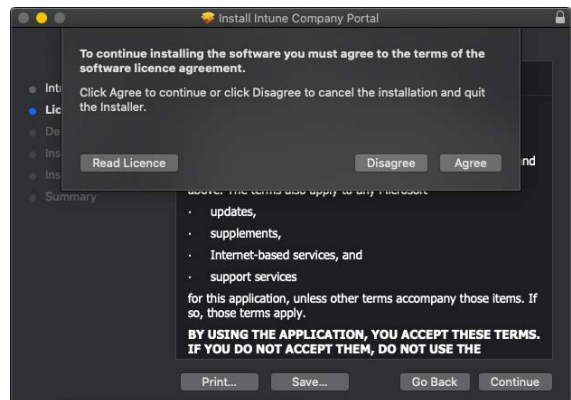

Click “Install” to commence the installation, entering your Mac password when asked.

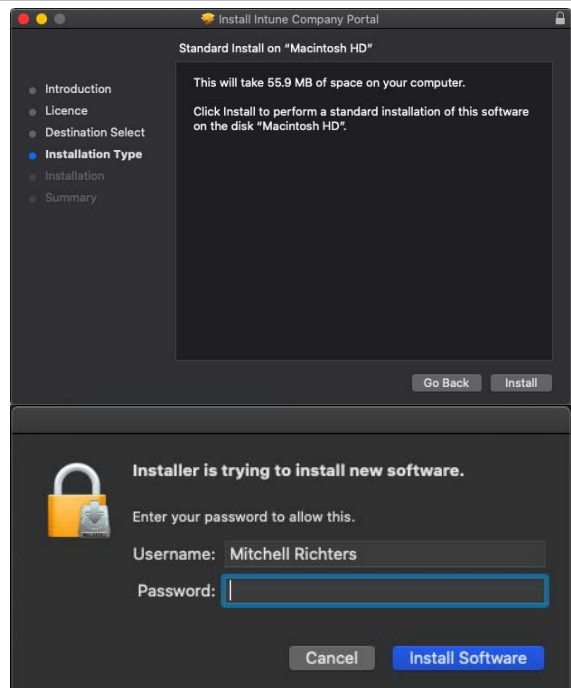

SGS Device Onboarding - macOS



ICT – How-To Guide

Last Updated: 20.01.2022

If asked, allow the installer access to your Downloads folder.

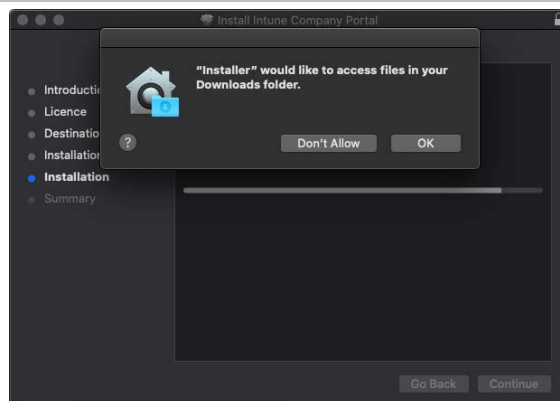

Click “Close” then “Move to Bin”.

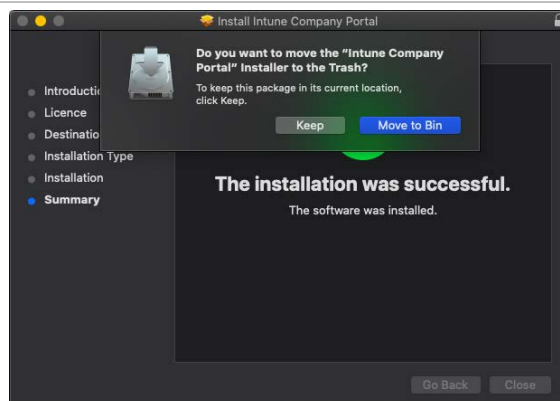

Ensure Microsoft AutoUpdate is set to “Automatically Download and Install”, then close the program.

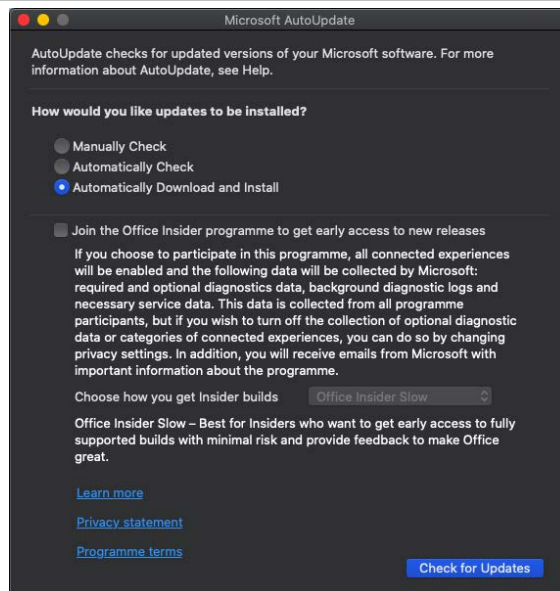

SGS Device Onboarding - macOS



ICT – How-To Guide

Last Updated: 20.01.2022

Press **⌘ + SpaceBar** to open Spotlight, then search for “Company Portal”, opening the top hit.

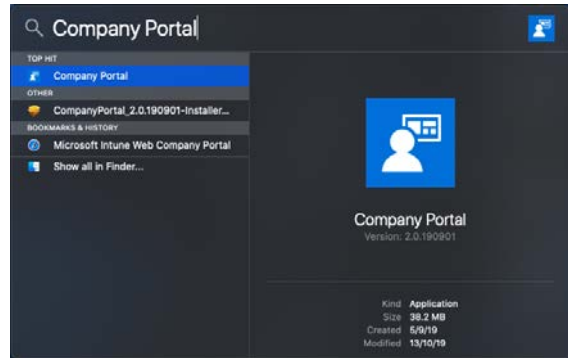

Click “Sign In” to commence the onboarding

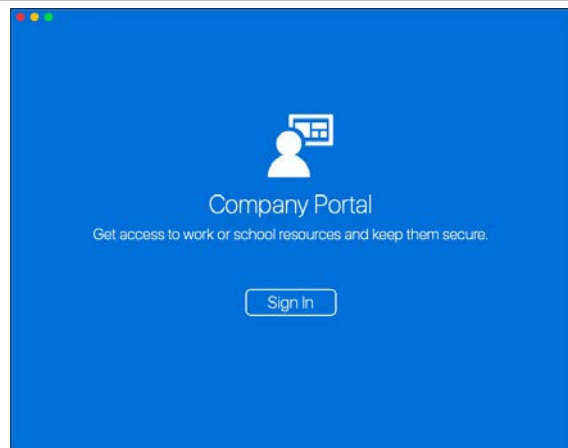

Enter your School password when asked.

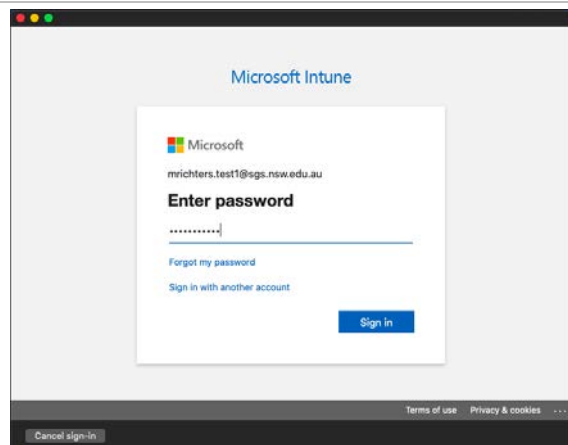

In the top right of the screen, click “Allow” Notification for Intune

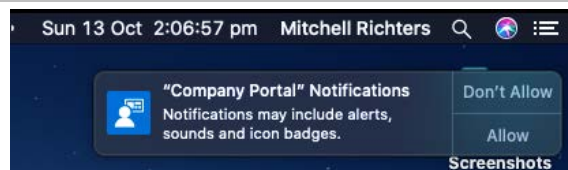

SGS Device Onboarding - macOS



ICT – How-To Guide

Last Updated: 20.01.2022

Click “Begin”

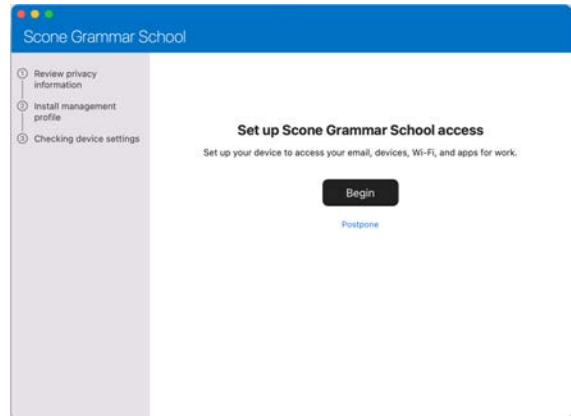

Click “Continue”

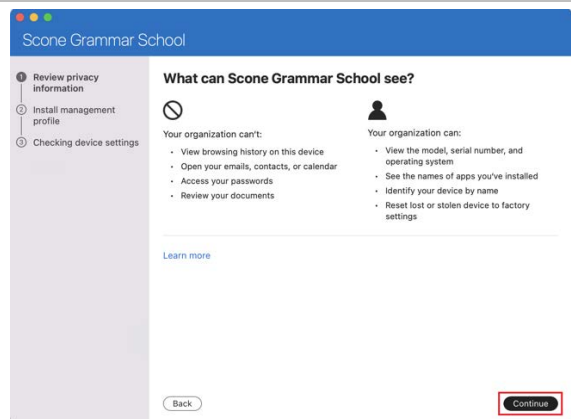

Click “Download profile”

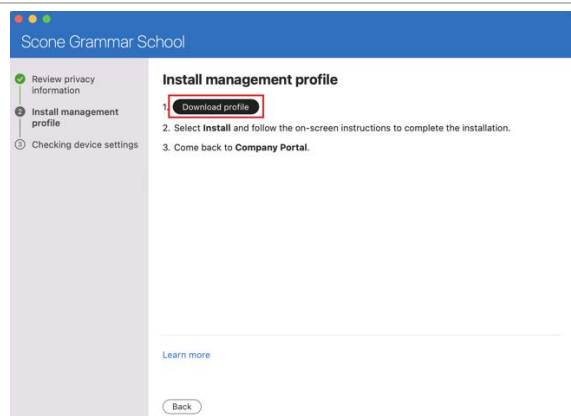

SGS Device Onboarding - macOS



ICT – How-To Guide

Last Updated: 20.01.2022

The Profiles settings page should open automatically.
Alternatively, you can go to “System Preferences > Profiles” and select “Management Profile”.
Click “Install” the profile.

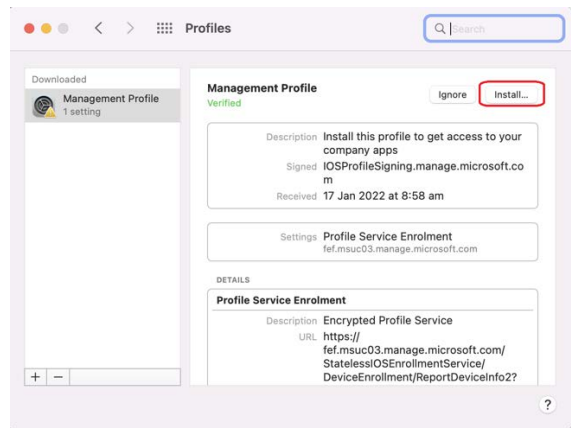

Click “Install” again.

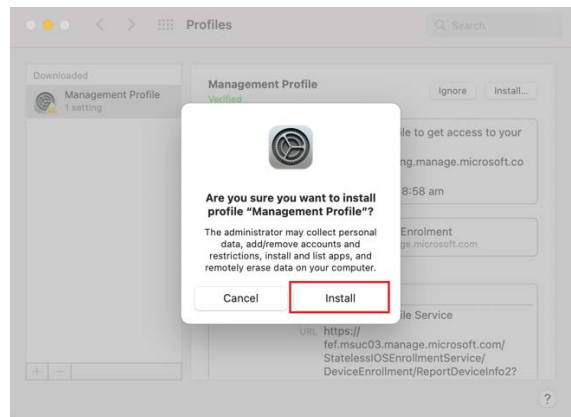

Enter your computer password, then click “Enrol”.

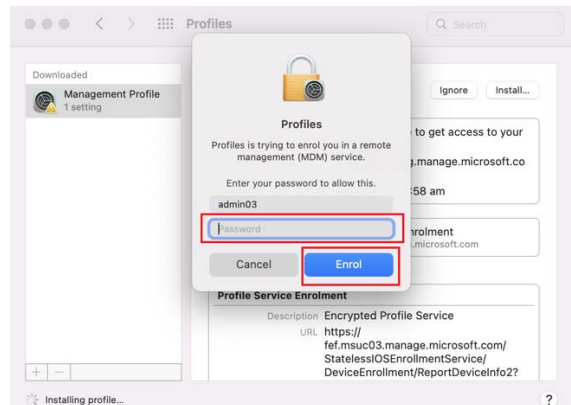

SGS Device Onboarding - macOS



ICT – How-To Guide

Last Updated: 20.01.2022

When prompted click “Done”.

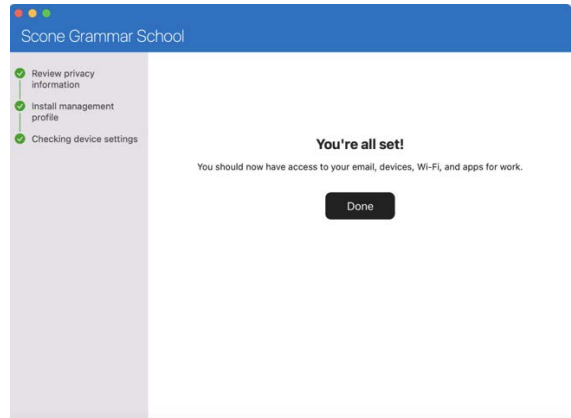

Please leave your laptop turned on and online for 1 hour to ensure all settings are applied correctly.